

Welcome to

**Hong Kong Sheng Kung Hui
(Anglican)
HOUSE OF PRAYER**

16 Ming Fai Road, Cheung Chau, Hong Kong
Tel: 2981 3375

Email : <hp@hkshk.org>

Mouth closing for God, Heart opening for God

House Directory

1. Rules and regulations	2
2. Floor map	4
3. Schedule and opening hours for meals, conference room and chapel	5
4. Using bathroom electric water heaters and hand-held fire extinguisher	6
5. Check out reminder	7
6. Ferry timetable and route map	8
7. Suggestions and feedback form	10
8. Dedication/Donation form	11

1. Rules and Regulations

I. **Our Mission :**

The House aims to provide a natural, tranquil and comfortable environment for Hong Kong Sheng Kung Hui clergy, laity, staff, and small fellowship groups to have retreat; and to offer the course of Clinical Pastoral Education (CPE) to staff and seminarians of different denominations of Christian Faith.

II. **Facilities :**

There are 22 rooms (8 double rooms, 12 single rooms, and 2 single suite for spiritual directors only), 8 prayer rooms (for 3-10 persons), 3 interview rooms, 1 reading room, a Chapel and a dining room for 30 persons. Air-conditioning is available indoor.

III. **Charges :** By donations suggested in the table below, which can normally claim deductions for tax purpose as the HKSKH is an approved charitable organizations.

Overnight camp (breakfast, lunch and dinner included)	Day camp (lunch and room included) Mon – Thurs except public holiday	Day camp (lunch included) Mon – Thurs except public holiday
HK\$400 per person (Single Suite HK\$550 per person for individual request)	HK\$300 per person (9am – 4pm)	HK\$200 per person (9am – 4pm)
Note: If user requests staying behind after check-out at 1:30pm, the suggested donation for continuously using the room facilities is HK\$100 per hour (per room). Subject to the availability		

IV. **Application Method :**

Applicant should first make a phone call to the House office at 2981-3375 for initial booking. After then the completed application/ donation forms, together with the donation cheque, have to be returned by mail within a week to Hong Kong Sheng Kung Hui, Provincial Office, Account Department, 16/F., Tung Wai Commercial Building, No. 109-111 Gloucester Road, Wan Chai, Hong Kong for awaiting the confirmation of booking. Please make your cheque payable to “Hong Kong Sheng Kung Hui” or “香港聖公會”.

V. **Items Provided :**

Quilt, pillow and bedding sheet will be provided by the House. Please bring along your personal effects and insect repellents.

VI. **Rules :**

In order to provide a clean and quiet environment for retreat, please follow the rules and regulations, always keep silence in common area and during meals, and appear in decent clothing.

VII. **Check-in and Check-out Arrangements☆ :**

Check-in	3:30p.m. (Our staff will welcome you and arrange room(s) for you in person.)
Check-out	12:30p.m. (Around 12:30pm, please place your room key into the key collection box in the dining room, and all your bedding sheets, including those for pillows, inside the collection box in the laundry room. As for garbage in your room and toilet, please put them into the garbage bin outside the laundry before leaving. And please clean your room and place your baggage in the reading room.)

☆ The main gate of the House closes at 7p.m. Lights are out at 11p.m.

VIII. **Meal Arrangement☆ :**

Breakfast	8:00a.m.	Lunch	12:30p.m.	Dinner	6:00p.m.
-----------	----------	-------	-----------	--------	----------

☆ Please have meals on time and clean your own dishes after meals. Please do not eat or drink outside the dining room.

IX. **Property Storage :**

Please take good care of your personal belongings, such as money, identity document(s) and valuables. The House will not be liable for any loss of property caused by fire hazard or campers' own fault.

X. **Arrangements for inclement weather :**

If Typhoon Signal No. 3 is hoisted or Yellow/Red Rainstorm Warning Signal is issued during your stay in the House, the booking will be held as scheduled. But if Typhoon Signal No. 8 or above is hoisted or Black Rainstorm Warning Signal is issued in advance on or before noon on the booking day, the booking will be cancelled. For those users already stay at the House, they may be requested to leave the House immediately subject to the actual weather condition and availability of ferry transportation. The House will not be liable for users' safety. If the booking is cancelled due to inclement weather condition, it can be rescheduled.

XI. The House reserves the right to make any changes to the content of the rules and regulations without prior notice.

XII. In case of any discrepancy between the Chinese and English version, the Chinese version shall prevail.

2. Prayer House Floor Map

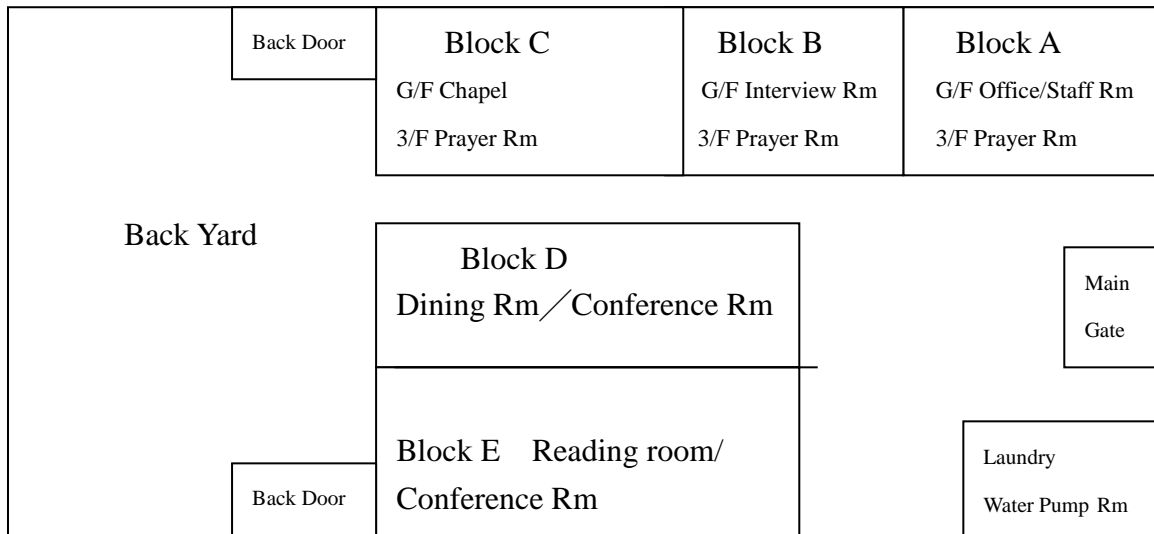

Blk A G/F Office/Staff Room
 1/F 2 Double Rooms (A201 、 A202) 、 Prayer Room
 2/F 2 Double Rooms (A301 、 A302) 、 Prayer Room

Blk B G/F Interview Room
 1/F 1 Single Suite (B200) 、 Interview Room
 2/F 1 Single Suite (B300) 、 Interview Room

Blk C G/F Chapel
 1/F 1 Double Room (C201 、 C202) 、 Prayer Room
 2/F 2 Double Rooms (C301 、 C302) 、 Prayer Room

Blk D G/F Dining Room / Conference Room
 1/F 3 Single Rooms (D201 、 D202 、 D203) 、 Prayer Room
 2/F 3 Single Rooms (D301 、 D302 、 D303) 、 Prayer Room

Blk E G/F Reading Room / Conference Room, Kitchen
 1/F 3 Single Rooms (E201 、 E202 、 E203) 、 Prayer Room
 2/F 3 Single Rooms (E301 、 E302 、 E303) 、 Prayer Room

Used Bed-Linen Collection : Please help to bring them to the laundry
 Garbage Collection : Put them in the garbage bin outside the laundry

3. Schedule and opening hours for meals, conference room and chapel

Dining Room Schedule for Meals	Conference Room Schedule	Chapel Available	
Breakfast 8:00am - 9:00am	9:30am -12:00nn	9:30am -12:00nn	
Lunch 12:30pm-1:30pm	2:00pm – 5:30pm	2:00pm – 5:30pm	
Dinner 6:00pm –7:00pm	8:00pm –10:00pm	7:00pm –10:00pm	

Remarks:

The dining room will be opened for 24 hours if no conference on that day.

4. Using bathroom electric water heaters and hand-held fire extinguisher

Using bathroom electric water heaters notes:

1. Switch on the electric water heater 20 minutes before use.
2. Next user please wait about 20 minutes before use.
3. The last user should switch off the electric water heater to save energy.

Please switch on the exhaust fan to maintain good air ventilation when using the electric water heater.

Using hand-held fire extinguisher program (located at each level's staircase and the dining room):

1. Shake the cylinder a few times, pull safety pin.
2. Aim at the base of fire (standing three meters away from fire).
3. Squeeze the handle sweep from left to right.
4. Report the fire to the office.

5. Check out reminder

Love Our Family, Serve One Another.

1. Please place all your used bed linen inside the collection box in the laundry, and put the garbage of your toilet and room to the garbage bin outside the laundry.
2. Please clean your room, prayer room, balcony and bathroom before check out. Cleansing utensils are placed along the staircase.
3. Please close all the doors and windows including the balcony's glass door and the iron gate on the roof, and switch off the water tapes, water heaters, and electric appliances.
4. Please kindly place your key inside the collection box in the dining room before 12:30p.m. (If room key is lost, suggested donation is HK\$50)
5. If any room facilities are found in need of repair, please contact our staff on duty directly.
6. Suggestions and Feedback Forms are located near the white board of the dining room, you are welcome to give your opinions and then put them in the collection box.

6. Ferry timetable and route map

Ferry Timetable

From Central to Cheung Chau

From Cheung Chau to Central

Mondays to Saturdays **Sundays and Public Holidays**

Mondays to Saturdays **Sundays and Public Holidays**

12:30 am	12:15 pm	12:30 am	12:00 nn	2:20 am	12:15 pm	2:20 am	12:00 nn
1:30	12:45	1:30	12:30 pm	5:10	12:45	5:10	12:30 pm
4:15	1:15	4:15	1:00	5:50	1:15	6:00	1:00
6:10	1:45	6:30	1:30	□ 6:20	1:45	6:30	1:30
7:00	2:15	7:00	2:00	6:40	2:15	7:00	2:00
7:40	2:45	7:30	2:30	7:00	2:45	7:30	2:30
8:00	3:15	8:00	3:00	7:15	3:15	8:00	3:00
8:40	3:45	8:30	3:30	7:45	3:45	8:30	3:30
9:00	4:15	9:00	4:00	7:50	4:15	9:00	4:00
9:45	4:45	9:30	4:30	7:55	4:45	9:30	4:30
10:15	5:20	10:00	5:00	8:10	5:15	10:00	5:00
10:45	5:40	10:30	5:30	8:20	5:40	10:30	5:30
11:15	6:00	11:00	6:00	8:40	6:20	11:00	6:00
11:45	6:20	11:30	6:30	9:00	7:00	11:30	6:30
	6:45		7:00	9:30	7:30		7:00
	7:00		7:30	10:00	8:00		7:30
	◆ 7:15		8:00	10:45	8:30		8:00
	■ 7:30		8:30	11:15	9:00		8:30
	◆ 7:40		9:00	11:45	9:30		9:00
	8:00		9:30		10:00		9:30
	8:30		10:00		10:30		10:00
	9:00		10:30		11:00		10:30
	9:30		11:00		11:30		11:00
	10:00		11:30		11:45		11:30
	10:30		11:55				
	11:00						
	11:30						
	11:45						

- Only available on Saturdays
- ◆ Only available on Mondays to Fridays except Public Holidays
- Berth at Central Pier No.6
- ▣ Ordinary Ferry & Freight Service available

The timetable is for reference only. The one provided by New World First Ferry shall prevail.

Location of the House of Prayer :

The prayer house is approximately 20 to 25 minutes' walk from Cheung Chau Pier.



Route map :

To get to the House from Cheung Chau Pier, you have to walk pass Tung Wan Road, St. John Hospital, Warwick Hotel and the helipad. Then, climb up the slope at the dressing room of Kwun Yam Beach until you reach the crossroad of Kwun Yam Temple. After that, follow Ming Fai Road and go up the mountain, pass the Caritas campsites, and walk along The Salvation Army Bradbury Camp to Fa Peng and the path of Chi Ma Hang and you will arrive at the House.

7. Suggestions and Feedback form

H.K.S.K.H. (Anglican) House of Prayer

16 Ming Fai Road, Cheung Chau, Hong Kong Phone: 2981 3375 Email: <hp@hkshk.org>

Please take a moment to complete this form to help us better serve you next time. Please put the completed form in the collection box at the dining room. Thank you!

Food & Beverage :

Room Environment ;

Service :

Other Suggestions :

8. Dedication/Donation form

H.K.S.K.H. (Anglican) House of Prayer

16 Ming Fai Road, Cheung Chau, Hong Kong Phone : 2981 3375 Email: <hp@hkskh.org>

Dedication/Donation Form

Your prayers and dedications are our support!

Our aim and mission :

To provide a natural, tranquil and comfortable environment for Hong Kong Sheng Kung Hui clergies, staff, brethrens and small fellowship groups to have retreat; and to offer the course of Clinical Pastoral Education (CPE) to staff and seminarians of different denominations of Christian Faith °

I would like to dedicate/donate \$ _____ for the following purposes :

- Retreat/ Spiritual formation (From _____ to _____)
- Individual spiritual counseling / Pastoral supervision (Suggested Donation HK\$400/session)
- Clinical Pastoral Education (CPE)
- Other(Please state purpose) _____

Information of dedicator/donor (Please complete in Chinese/English BLOCK letters)

Name : _____ Contact No. : _____

Address : _____

_____ E-mail : _____

(Information collected is only for sending receipts and newsletter and is abide by the Personal Data (Privacy) Ordinance.)

Method

- Cheque (Bank _____ Cheque no. _____)

Please make a cross cheque payable to “Hong Kong Sheng Kung Hui” or “香港聖公會” (Please have your name and contact no. printed at the back) and send it to “Hong Kong Sheng Kung Hui, Provincial Office, Account Department, 16/F., Tung Wai Commercial Building, No. 109-111 Gloucester Road, Wan Chai, Hong Kong” together with this /and the retreat form.